

Plan For New Congregational Church 9-7-52

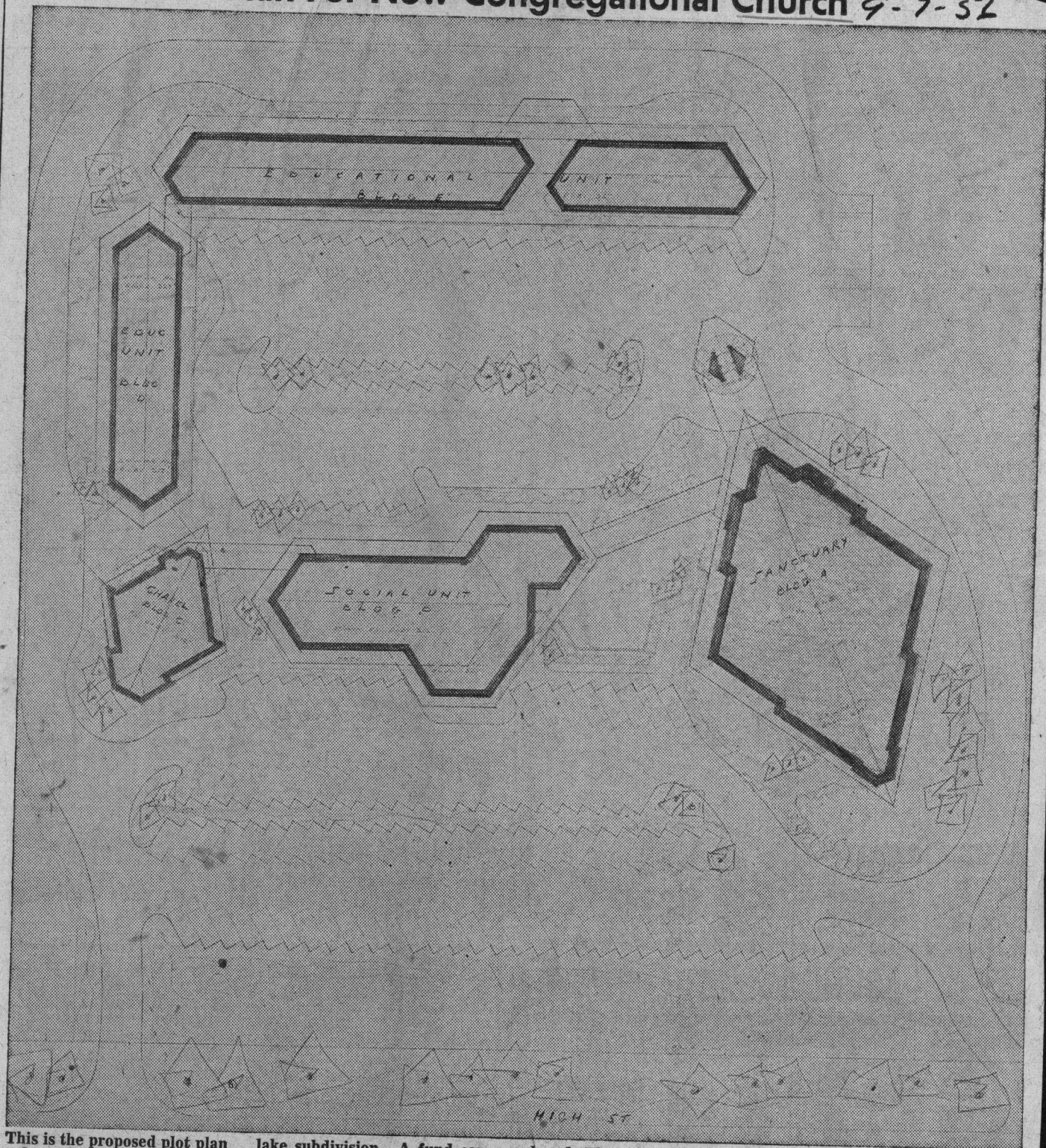

This is the proposed plot plan for the new First Congregational church, which, when approved by the members, will be built on a four-acre hillside on High street, across from the West-

lake subdivision. A fund campaign within the church membership will be launched October 20. Church units are grouped college campus style. Lower right is the sanctuary. Left of it is the social hall, and a small

chapel. The other three buildings above are the Christian education buildings. A church tower sits directly back of the sanctuary. All the buildings will be connected by breezeways and all the roofs will feature a six-

foot overhang for protection in rainy weather. Spaces for some 175 cars are provided in the center of the building circle and on the High street frontage.